

FORM No. 1.

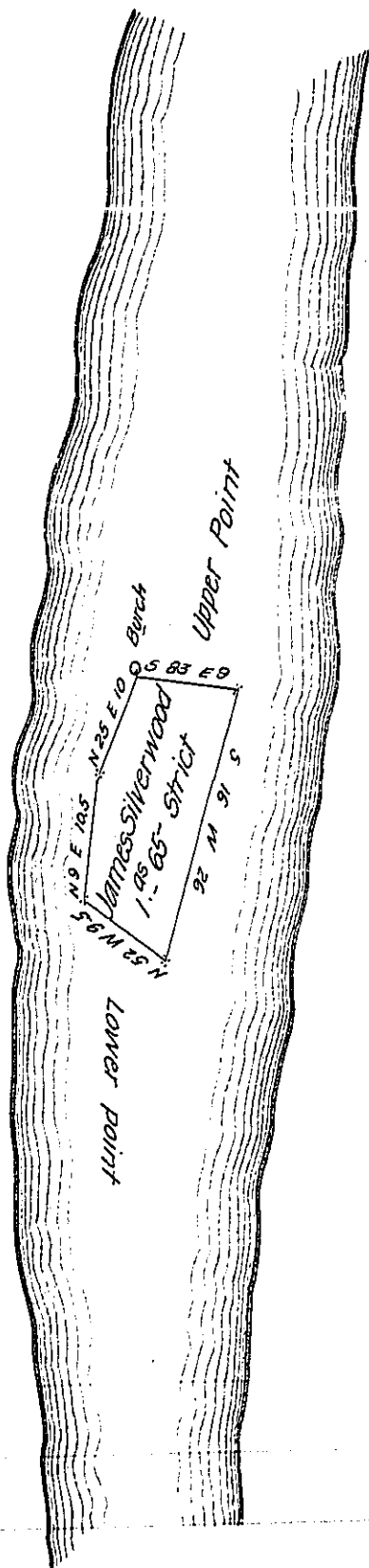

Situate in the River Susquehanna Called Duck Harbor in Augusta Township Northumberland County opposite to Lands of s^d-Silverwood on the East side of s^d river and about five miles below Sunbury Containing one acer & sixty five purch Strict Measure. Surveyed the 22 day of July 1814 unto James Silverwood by virtue of his warrant baring date the 13 day of July 1814

Jacob Rockefeller D.S.

To Rich^d T. Leech Esqire

Surveyor General.

IN TESTIMONY that the above is a copy of the original remaining on file in the Department of Internal Affairs of Pennsylvania, made comformably to an Act of Assembly approved the 16th day of February 1833, I have hereunto set my hand and caused the Seal of said Department to be affixed at Harrisburg, this tenth day of April 1907

James D. Brown
Secretary of Internal Affairs.